

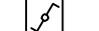





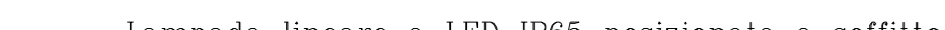

LEGENDA IMPIANTO ELETTRICO

-  Interruttore singolo
-  Deviatore
-  Presa bipolare + presa tripolare tipo CEE con interruttore di blocco 16A
-  Lampada lineare a LED IP65 posizionata a soffitto
-  Lampada a LED a soffitto
-  Quadro di zona
-  Prese singole da 16A
-  Corpi illuminanti - illuminazione indiretta
-  Corpi illuminanti - illuminazione diretta
-  Rilevatore di presenza
-  Apparecchio autonomo illuminazione d'emergenza posizionato a soffitto

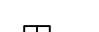
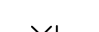
REGIONE AUTONOMA VALLE D'AOSTA
COMUNE DI VALTOURNENCHE

OGGETTO:
progetto di fattibilità tecnico economica per realizzazione di una struttura da adibire a sala polifunzionale in località Breuil-Cervinia del comune di Valtournenche

PROGETTISTI:
Marco Maresca architetto
Massimo Desalvo architetto

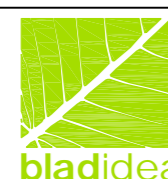

Silvano Cheraz ingegnere
Augusto Fosson ingegnere

settembre 2021

PROGETTO
Schema impianto elettrico

Tavola: 1 imp

Scala grafica: 1:100

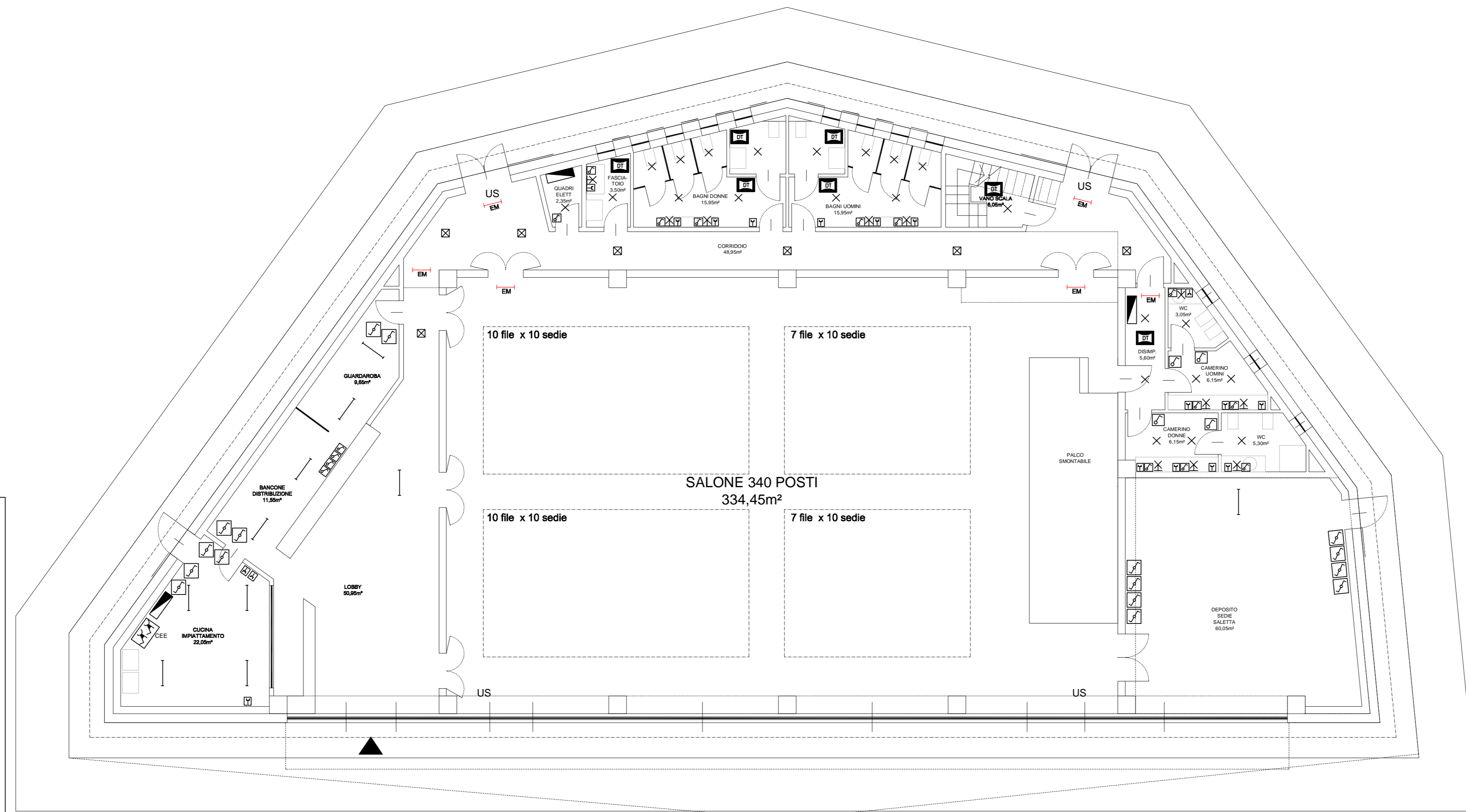

PIANO TERRENO

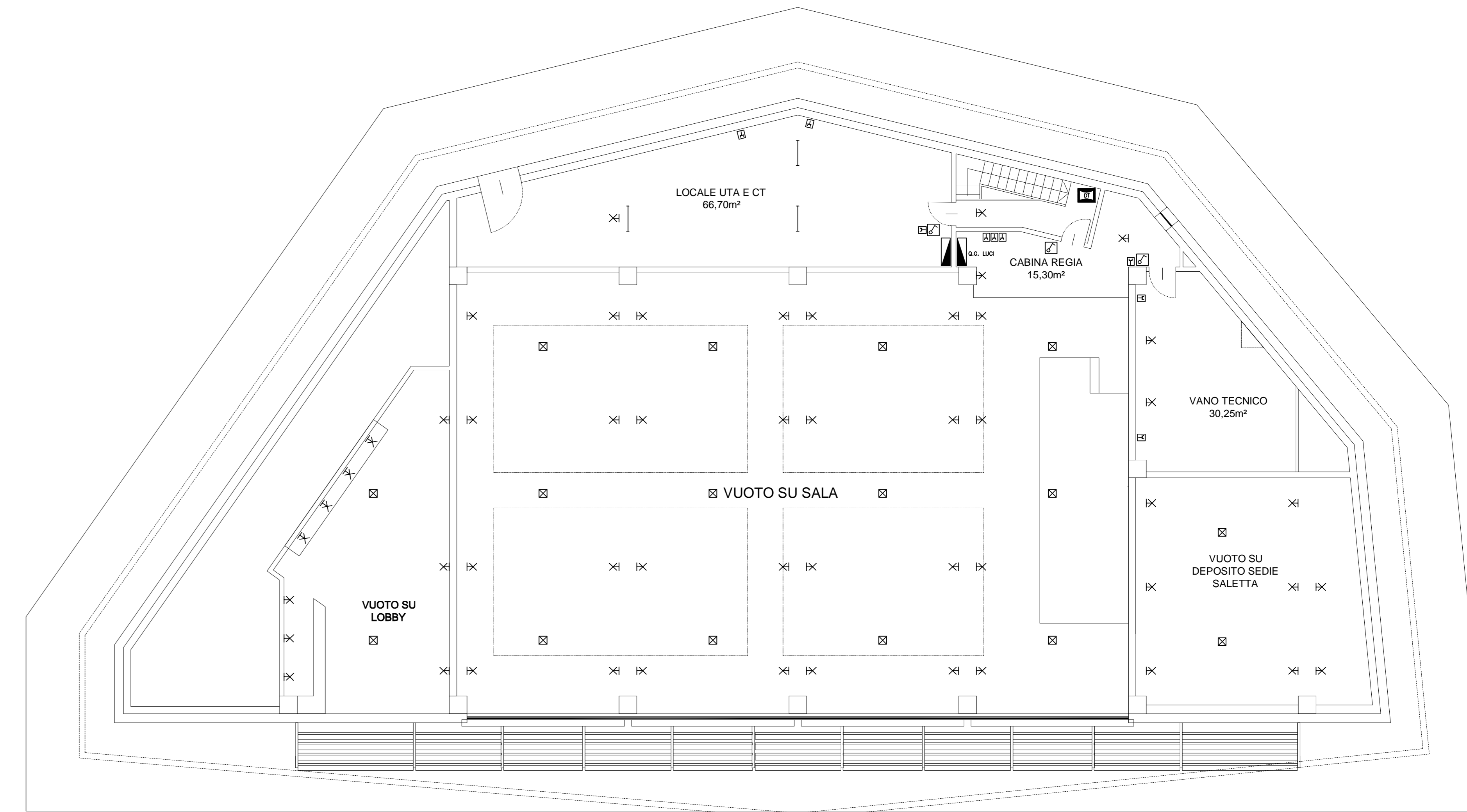

PIANO PRIMO